

Other lands of Phillip Foulk

Courses & Distances of
Shermans Creek

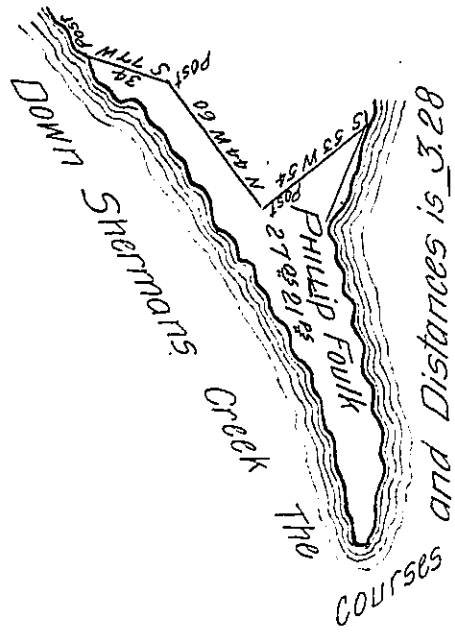

- S 56 E 24
- S 40 E 92
- S 27 E 60
- N 12 E 32
- N 15 W 80
- N 45 E 36.3

The Draft of a tract of land Situate in Fye Township Cumberland County Contain-
 ing Twenty Seven Acres and Twenty one perches & allowances Surveyed 30th
 October 1816 In pursuance of a Warrant Granted to Phillip Foulk Dated 15th June
 1812.

Robt Clark D.S.

To Richd T. Leech Esq }
 Surveyor General of Pennsylvania }

IN TESTIMONY that the above is a copy of the original remaining on file in
 the Department of Internal Affairs of Pennsylvania, made
 conformably to an Act of Assembly approved the 16th day of
 February, 1833, I have hereunto set my Hand and caused
 the Seal of said Department to be affixed at Harrisburg,
 this twenty second day of November 1904

Isaac P. Brown
 Secretary of Internal Affairs.